

## FAQ

**Q: Where is the new building located?**

A: The new City Hall building will be located just south of the current building on the same site.

**Q: What is the project cost?**

A: \$22.25 million, funded through general obligation capital improvement bonds and accumulated reserves.

**Q: What is the building size?**

A: 98,000 square feet. Although significantly larger than the old building, much of the space is dedicated for underground parking of public safety vehicles and additional meeting rooms.

**Q: Why is the building needed?**

A: The current building is badly deteriorated, does not meet accessibility standards, and is not energy efficient. A citizen task force has studied the issue since 2004 and recommended construction of a new facility.

**Q: Will Heredia Park close during construction?**

A: Yes. However, the park will be restored at the end of construction. Planned enhancements include a plaza, pergola, gardens, and fountain behind City Hall.

## Who to Contact:

Staff Contact:  
Pam Dmytrenko,  
Assistant to the City Manager  
612-861-9708  
[newcityhall@cityofrichfield.org](mailto:newcityhall@cityofrichfield.org)

### Facebook:

Search Richfield Police, Fire and City Hall Facility and follow our Facebook page.

### Twitter:

Updates will also be posted on the City's Twitter page. Links to both are at [www.cityofrichfield.org](http://www.cityofrichfield.org).



**City of Richfield  
Police, Fire & City Hall Facility  
Project Information**

City of Richfield  
6700 Portland Avenue  
Richfield, MN 55423  
Phone: 612-861-9700  
Fax: 612-861-9749  
E-mail: [newcityhall@cityofrichfield.org](mailto:newcityhall@cityofrichfield.org)



## City of Richfield

### Police, Fire & City Hall Facility Project



Construction Timeline:  
October 2009 - June 2011

City of Richfield  
Police, Fire & City Hall Facility  
Project Information

**Tel: 612-861-9708**



## Richfield Police, Fire & City Hall Facility Summary

When it opens in 2011, the Richfield Police, Fire & City Hall Facility will feature more amenities and services than the old building.

Included in the 98,000 square-foot facility is underground parking for public safety vehicles. There are also drive-through bays for the fire department. And, the new facility will service the public better with a larger licensing center and additional meeting rooms.

The two-story brick building is designed to be compatible with the surrounding park and neighborhood. Landscaping and park enhancements are included.



*Above: Rendering from Portland Avenue entrance.*

### Construction Phasing:

#### Phase 1: (Oct. 2009 - Feb. 2011)

- New building is constructed.
- Temporary parking: 35 stalls along Portland. 31 stalls on tennis courts.
- Existing City Hall to remain OPEN. Heredia Park closes temporarily.

#### Phase 2: (March 2011 - July 2011)

- Existing building will be demolished and new parking lot constructed.
- Landscaping work is completed.
- Temporary parking: 12 stalls along Portland Avenue. 31 stalls on tennis courts. New garage available for public safety vehicles.
- Heredia Park restored and enhanced.

*Below: Rendering from Heredia Park*

### Construction Phasing Diagrams:

#### Phase I

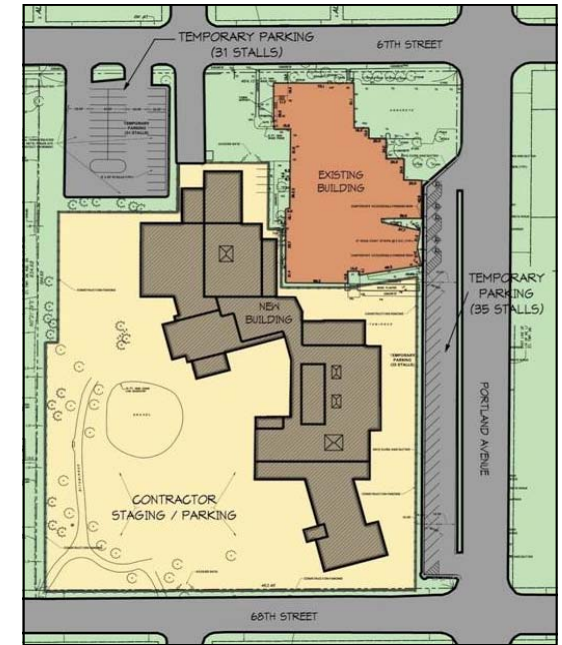

#### Phase 2

